

Content



1. General

Operating temperature: -10°C to +60°C component weight [g]:
 Storage temperature: -25°C to +70°C
 Contact: Connector housing color: black
 Packageing: tray IP rating:
 ESD conform
 RoHs conform: yes
 Remark:

Housing material flame resistant ABS, rubber between inside loudspeaker frame and housing, dimensions 68.5x38.9mm, Load test (Input Power 1W, Temperature +70°, Duration 2000hrs), Heat test (Temperature +70 ± 2° C, Relative humidity MAX 23.71%RH, Duration 96hrs), Cold test (Temperature -25 ± 3° C, Duration 96hrs), Moisture Test (Temperature +40 ± 2° C, Humidity 100 ± 2% (RH), Duration 96hrs), Drop test (Surface concrete floor or steel, Height 75cm, Direction X,Y&Z 3axes)
 The part have to fulfill the following standards:
 loudspeakers UL 94 min class HB, housing UL94 5VB FLAMMABILITY STANDARD, RoHS - EU standard 2002/95/EC, EG VO 1907/2006 REACH, UL 197 Commercial Electric Cooking Appliances, EN 60335-1 and -2-42

2. Electrical and acoustical specification

Description	Condition	Value
Impedance [Ω]	at 1kHz	8 ± 20%
Resonance frequency [Hz]		250 +/- 50
Frequency range [Hz]		200 - 15000
Sound pressure level SPL [dB]	1m / 1W / 1kHz	85 ± 5
Rated input power [W]		1
Maximum power [W]		2
Buzz & Rattle	must be normal (at sine wave 2.83v)	

Transmittal, reproduction, dissemination and / or editing of this documents as well as utilization of its contents and communication thereof to others without express authorization are prohibited. Offenders will be held liable for payment of damages. All rights created by patent grant or registration of a utility model or design patent are reserved.

GREWUS		dimensions without tolerance: +/- 0.5	scale:	
Designed by: Ralf Hinnerichs	15.11.2010	part number: SH6808C-01A	index:	Last update:
Released by: Hinnerichs	11.06.2013		A	11.06.2013
drawing number: 404973896		Loudspeaker	Page 1 of 4	

3. Frequency curve

Test assembly

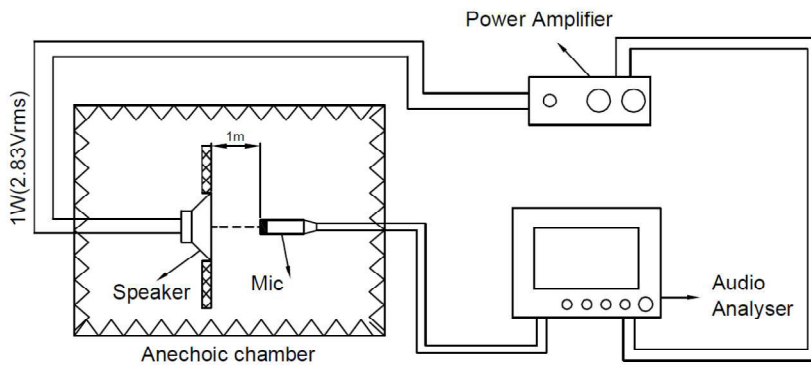

Frequency curve

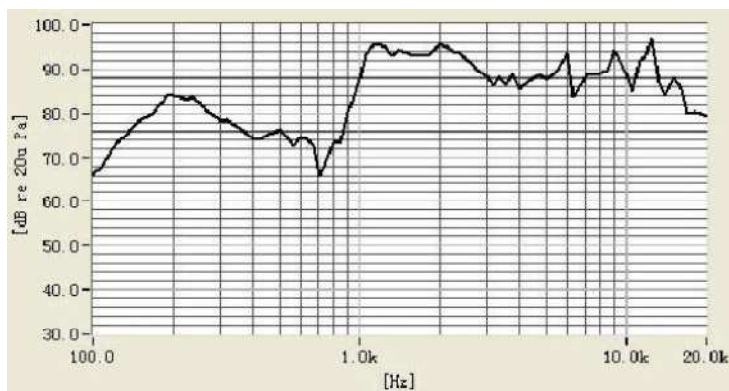

Frequency Response
 20.00 µPa/V 1/12Oct
 1W / 1m

Impedance curve

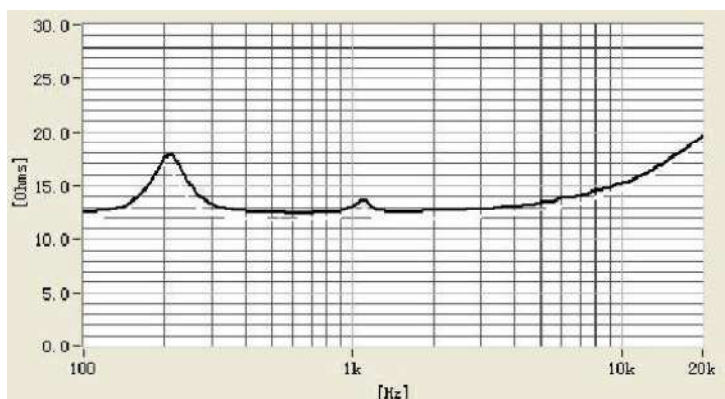

1W / 1m

GREWUS			Dimensions without tolerance +/- 0.5	Scale	
Designed by	Hinnerichs	15.11.2010	Part number SH6808C-01A	Index	Date
Released by	Hinnerichs	11.06.2013		A	11.06.2013
Drawing number 404973896				Page 2 of 4	

4. Drawing

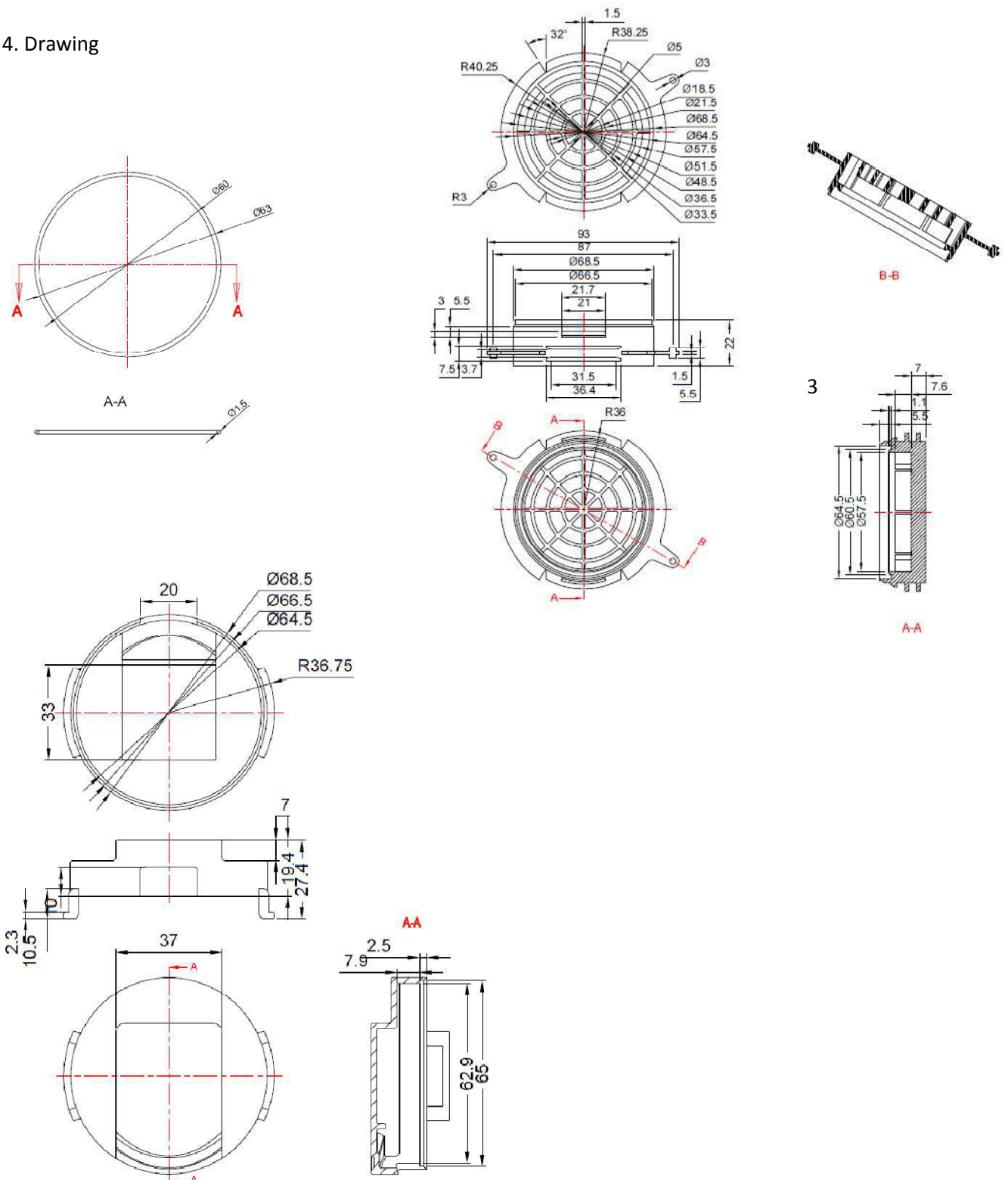

GREWUS			Dimensions without tolerance +/- 0.5		Scale	
Designed by	Hinnerichs	15.11.2010	Part number SH6808C-01A		Index	Date
Released by	Hinnerichs	11.06.2013			A	11.06.2013
Drawing number 404973896					Page 3 of 4	

5. Reliability test conditions

5.1 Load test

Input Power 1W

Duration use white noise EIA filter for 8hours with voltage test 2000hrs

5.2 Heat temperature test

Temperature +70±2°C

Relative humidity 20...50%RH, Duration 8hrs

5.3 Cold temperature test

Temperature -25±3°C, Duration 8hrs

5.4 Temperature shock test

Low Temperature -10± 3°C, High Temperature +55± 2°C

Dwell time each temperature 30min, transfer time from lower to upper temperature<10s

Cycles 100

5.5 Moisture Test

Temperature +40± 2°C, Humidity 92± 2% (RH), Duration 8hrs

5.6 Drop test

Surface (floor) concrete or steel

Height 75cm, Direction X,Y&Z 3 axes

5.7 UL 94 5VB FLAMMABILITY STANDARD

Requirements for 5VA

1. The specimens may not burn with flaming or glowing combustion for more than 60 seconds after the fifth application of the test flame.

2. The specimens may not drip flaming particles that ignite the dry absorbent surgical cotton located 300mm below the test specimen.

3. Plaques specimens may not exhibit burn through.

After the test, all electronic and acoustic characteristic should be satisfied with the specification.

SPL: Deviation is of ±2dB of initial value.

GREWUS			Dimensions without tolerance +/- 0.5	Scale	
Designed by	Hinnerichs	15.11.2010	Part number SH6808C-01A	Index	Date
Released by	Hinnerichs	11.06.2013		A	11.06.2013
Drawing number 404973896				Page 4 of 4	