

# HU 2SPL A

## BACKUP ALARM

### CONTENT

1. Specifications
2. Drawing
3. Test Method
4. Reliability Test
5. Packing
6. History Change Record



### 1. SPECIFICATIONS

Parameter	Unit	Conditions / Description	MIN	TYP	MAX
Rated Voltage	V			12/24	
Operating Voltage	VDC		8		30
Current consumption	mA				300
Resonance Frequency	Hz		880	1.100	1.320
High SPL	dB	In 1m distance	90	95	100
		In 7.5m distance	68	73	78
Low SPL	dB	In 1m distance	73	78	83
		In 7.5m distance	52	55	58
ON-OFF-cycles	C/M		60	80	100
Leading wire		Red+, black-			
IP Rating	IP			67	
Modulation				PULSE TONE	
Housing Colour				BLACK	
Contact				WIRE	
Packaging				BOX	
Operating Temperature	°C		-20		+80
Storage Temperature	°C		-20		+80
Weight	g			85	

**Remark:** The alarm starts with SPL High when the red wire is connected with power. Cut the trigger voltage for  $\leq 1.5s$  and connect the voltage again, then the SPL will switch over to SPL Low. Cut the trigger voltage for  $\geq 1.5$  and then connect with voltage again, the SPL will be switched back to High SPL

DESIGNED BY	Ralf Hinnerichs	DATE	2007.11.09	PART NO.	HU 2SPL A	INDEX	A
RELEASED BY	Ralf Hinnerichs	DATE	2007.11.09				
CHANGED BY	Rabea Richter	DATE	2019.08.30				
DRAWING NO.	393955297						

### 2. DRAWING

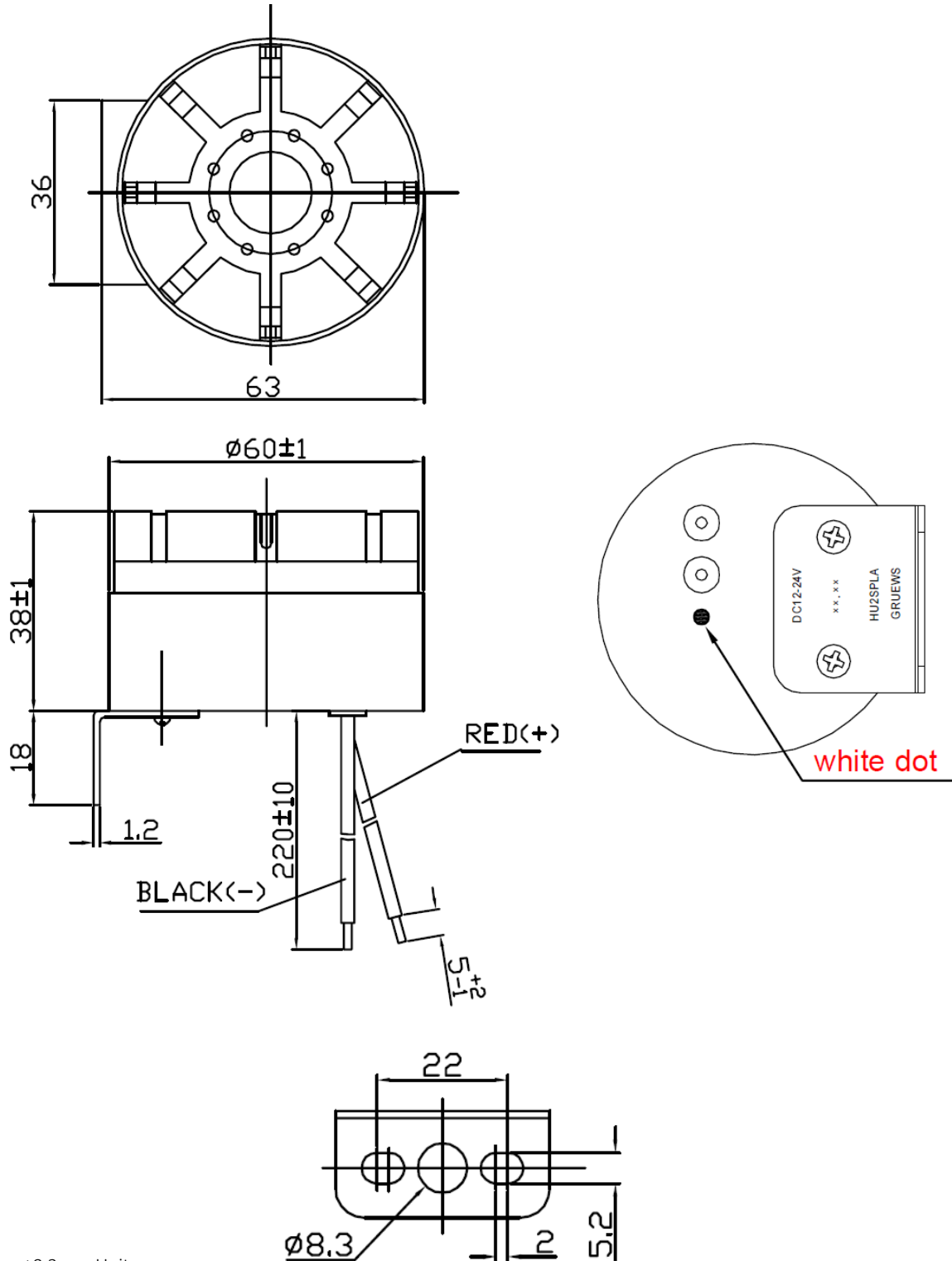

Tolerance ±0.2 Unit: mm

DESIGNED BY	Ralf Hinnerichs	DATE	2007.11.09	PART NO.	HU 2SPL A	INDEX	A
RELEASED BY	Ralf Hinnerichs	DATE	2007.11.09				
CHANGED BY	Rabea Richter	DATE	2019.08.30				
DRAWING NO.	393955297						

### 3. TEST METHOD

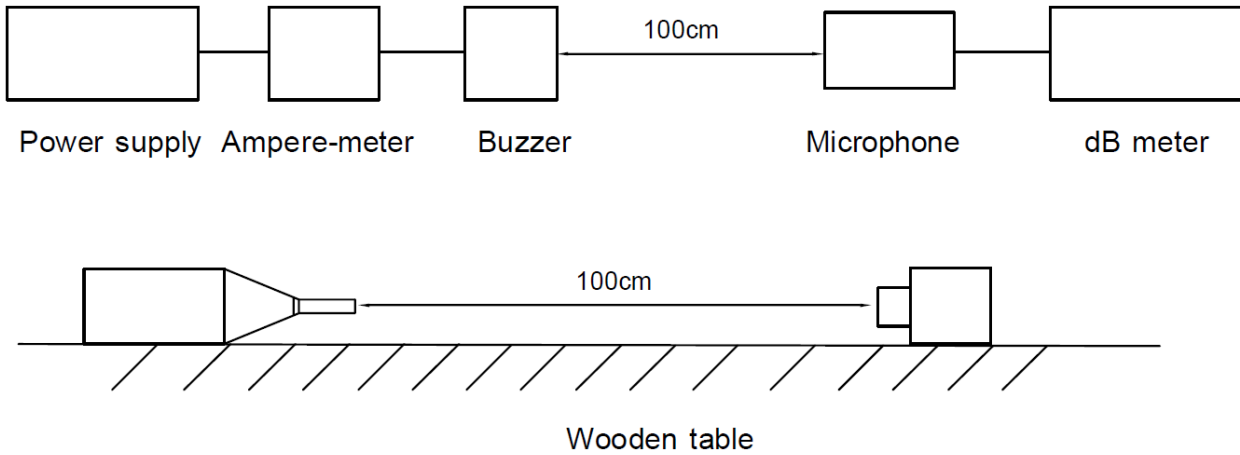

### 4. RELIABILITY TEST

#### 4.1 Low Temperature Test

Temperature -20 °C  
Duration 98 hours

#### 4.2 High Temperature Test

Temperature +80°C  
Duration 98 hours

#### 4.3 Humidity Test

Temperature +40°C  
Humidity 95% RH  
Duration 98 hours

#### 4.4 Durability Test

Testing after 1000hours actual continuous operation

#### 4.5 Drop Test

Height 75cm  
Direction x, y, z, 3 axes

**Notice:** No abnormality shall exist

DESIGNED BY	Ralf Hinnerichs	DATE	2007.11.09	PART NO.	INDEX
RELEASED BY	Ralf Hinnerichs	DATE	2007.11.09	HU 2SPL A	A
CHANGED BY	Rabea Richter	DATE	2019.08.30		
DRAWING NO.	393955297				

### 5. PACKING

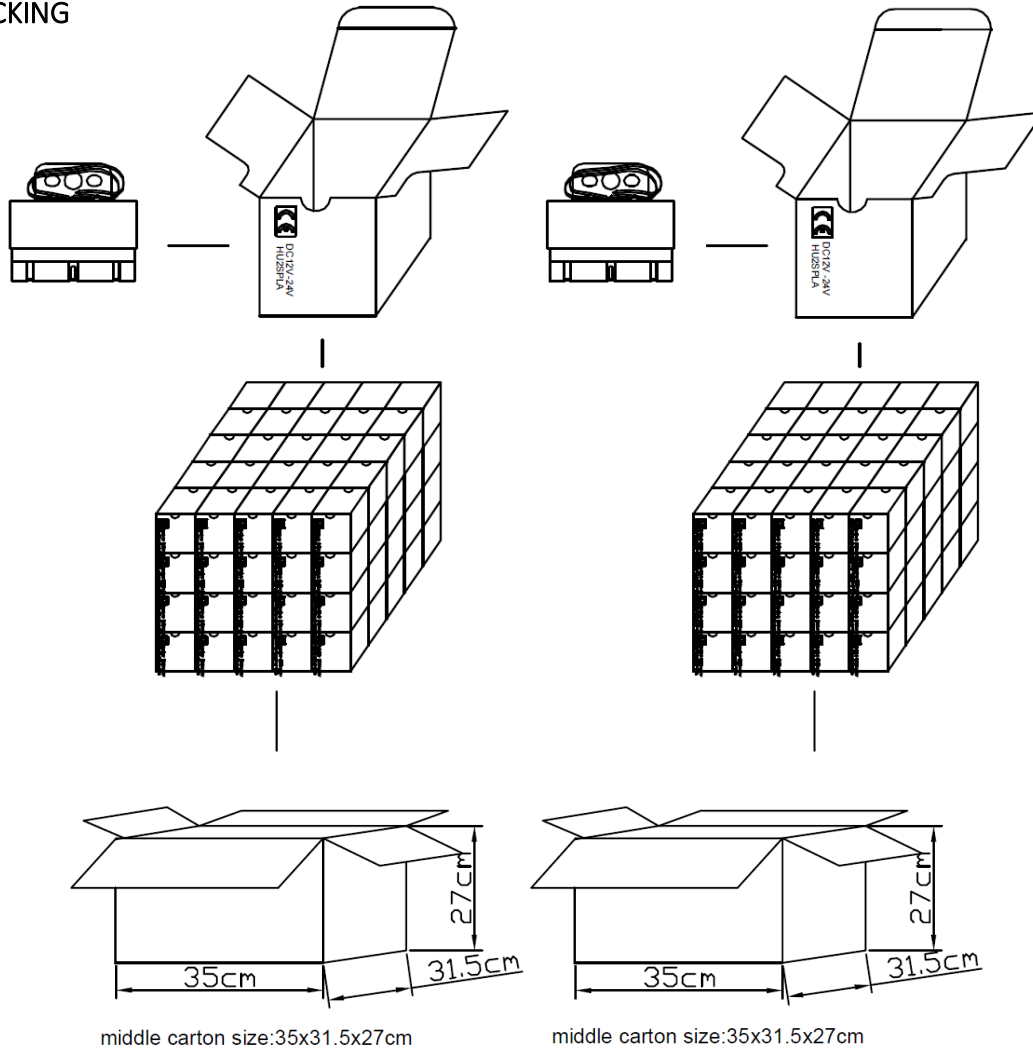

#### 5.1 PACKING QUANTITY

1pcs per box  
 20 boxes per middle carton  
 2 middle cartons per carton  
 200pcs per carton in total  
 Carton size 37x33.5x56cm

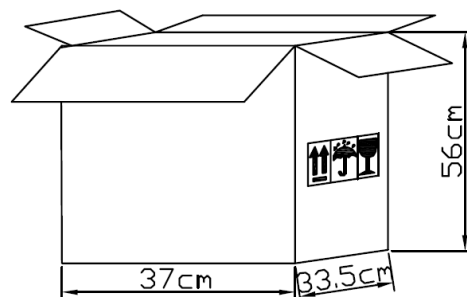

DESIGNED BY	Ralf Hinnerichs	DATE	2007.11.09	PART NO.	HU 2SPL A	INDEX	A
RELEASED BY	Ralf Hinnerichs	DATE	2007.11.09				
CHANGED BY	Rabea Richter	DATE	2019.08.30				
DRAWING NO.	393955297						

6. HISTORY CHANGE RECORD

REV	CHANGE ITEMS		DATE
	BEFORE CHANGE	AFTER CHANGE	
1	Old Layout	New Layout	2019.08.02
2		Add Test Method and Reliability Test	2019.08.30

DESIGNED BY	Ralf Hinnerichs	DATE	2007.11.09	PART NO.	HU 2SPL A	INDEX	A
RELEASED BY	Ralf Hinnerichs	DATE	2007.11.09				
CHANGED BY	Rabea Richter	DATE	2019.08.30				
DRAWING NO.	393955297						